

Strength
Reliability
Security

Intelligent Solutions For Your Comfort

Technical
Catalog

Aluminium Window Profiles with 16mm Groove

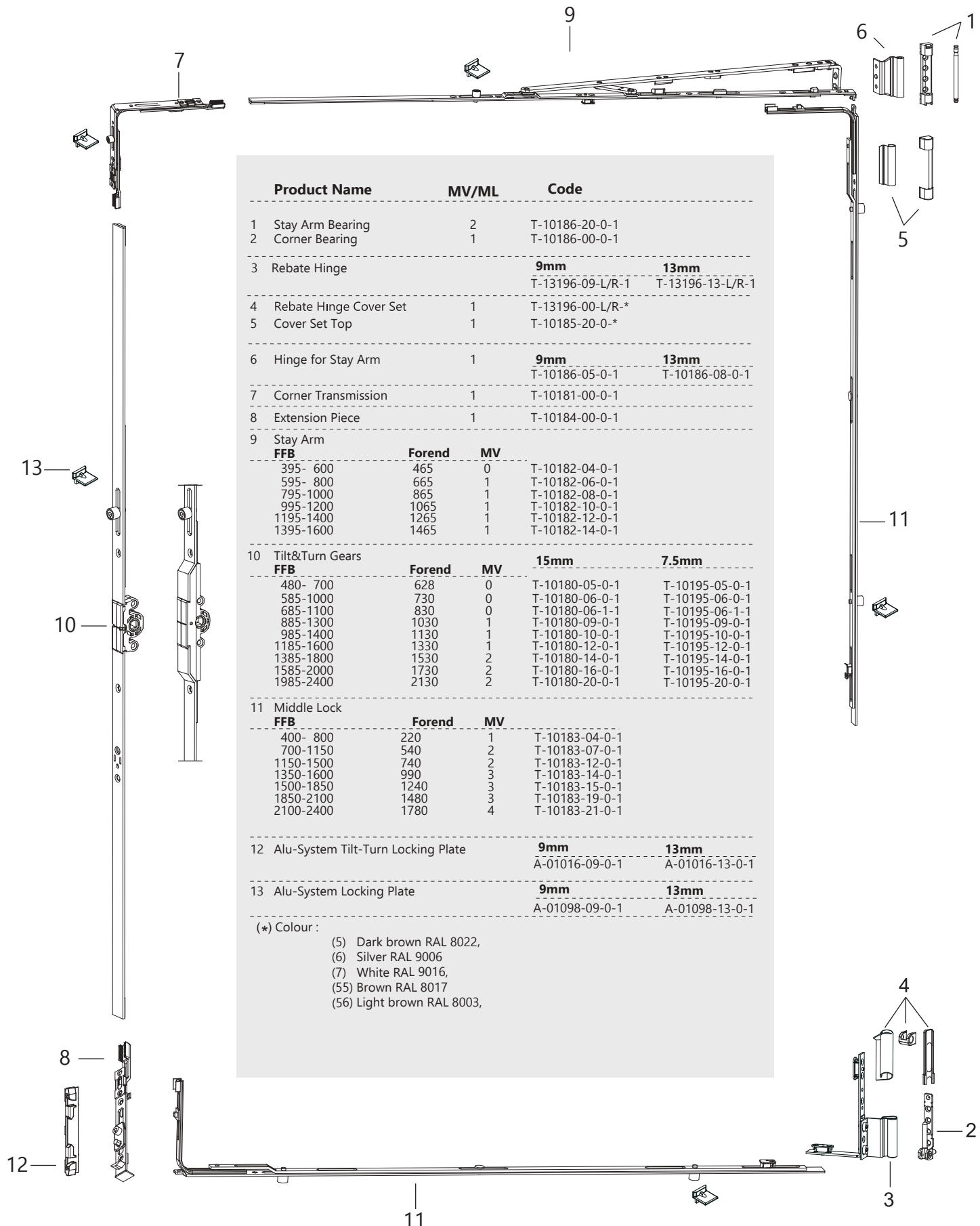

Product Name	MV/ML	Code	
1 Stay Arm Bearing	2	T-10186-20-0-1	
2 Corner Bearing	1	T-10186-00-0-1	
3 Rebate Hinge		9mm	13mm
		T-13196-09-L/R-1	T-13196-13-L/R-1
4 Rebate Hinge Cover Set	1	T-13196-00-L/R-*	
5 Cover Set Top	1	T-10185-20-0-*	
6 Hinge for Stay Arm	1	9mm	13mm
		T-10186-05-0-1	T-10186-08-0-1
7 Corner Transmission	1	T-10181-00-0-1	
8 Extension Piece	1	T-10184-00-0-1	
9 Stay Arm			
FFB	Forend	MV	
395- 600	465	0	T-10182-04-0-1
595- 800	665	1	T-10182-06-0-1
795-1000	865	1	T-10182-08-0-1
995-1200	1065	1	T-10182-10-0-1
1195-1400	1265	1	T-10182-12-0-1
1395-1600	1465	1	T-10182-14-0-1
10 Tilt&Turn Gears		15mm	7.5mm
FFB	Forend	MV	
480- 700	628	0	T-10180-05-0-1
585-1000	730	0	T-10180-06-0-1
685-1100	830	0	T-10180-06-1-1
885-1300	1030	1	T-10180-09-0-1
985-1400	1130	1	T-10180-10-0-1
1185-1600	1330	1	T-10180-12-0-1
1385-1800	1530	2	T-10180-14-0-1
1585-2000	1730	2	T-10180-16-0-1
1985-2400	2130	2	T-10180-20-0-1
11 Middle Lock			
FFB	Forend	MV	
400- 800	220	1	T-10183-04-0-1
700-1150	540	2	T-10183-07-0-1
1150-1500	740	2	T-10183-12-0-1
1350-1600	990	3	T-10183-14-0-1
1500-1850	1240	3	T-10183-15-0-1
1850-2100	1480	3	T-10183-19-0-1
2100-2400	1780	4	T-10183-21-0-1
12 Alu-System Tilt-Turn Locking Plate		9mm	13mm
		A-01016-09-0-1	A-01016-13-0-1
13 Alu-System Locking Plate		9mm	13mm
		A-01098-09-0-1	A-01098-13-0-1

(*) Colour :
 (5) Dark brown RAL 8022,
 (6) Silver RAL 9006
 (7) White RAL 9016,
 (55) Brown RAL 8017
 (56) Light brown RAL 8003,

Aluminium Window Profiles with 16mm Groove

Corner Transmission



T-10181-02-0-1
Corner Transmission, (se)



T-10181-03-0-1
Corner Transmission Small



T-10181-04-0-1
Corner Transmission Small (se)

Optional Parts for Gears



T-10189-63-0-1
Extension 630mm



T-10189-42-0-1
Extension 420mm

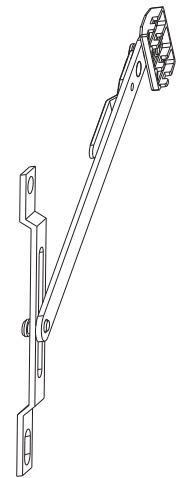

T-90001-00-0-1
Security Plate

Locking Plate

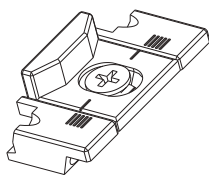

A-01090-00-0-1
Alu-System Adjustable Locking Plate

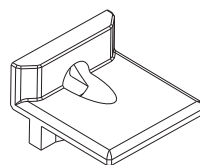

A-01098-09-S-1
Alu-System Locking Plate 9mm (se)

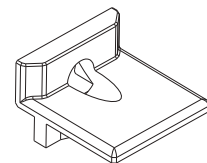

A-01098-10-0-1
Alu-System Locking Plate 10mm

Aluminium Window Profiles with 16mm Groove

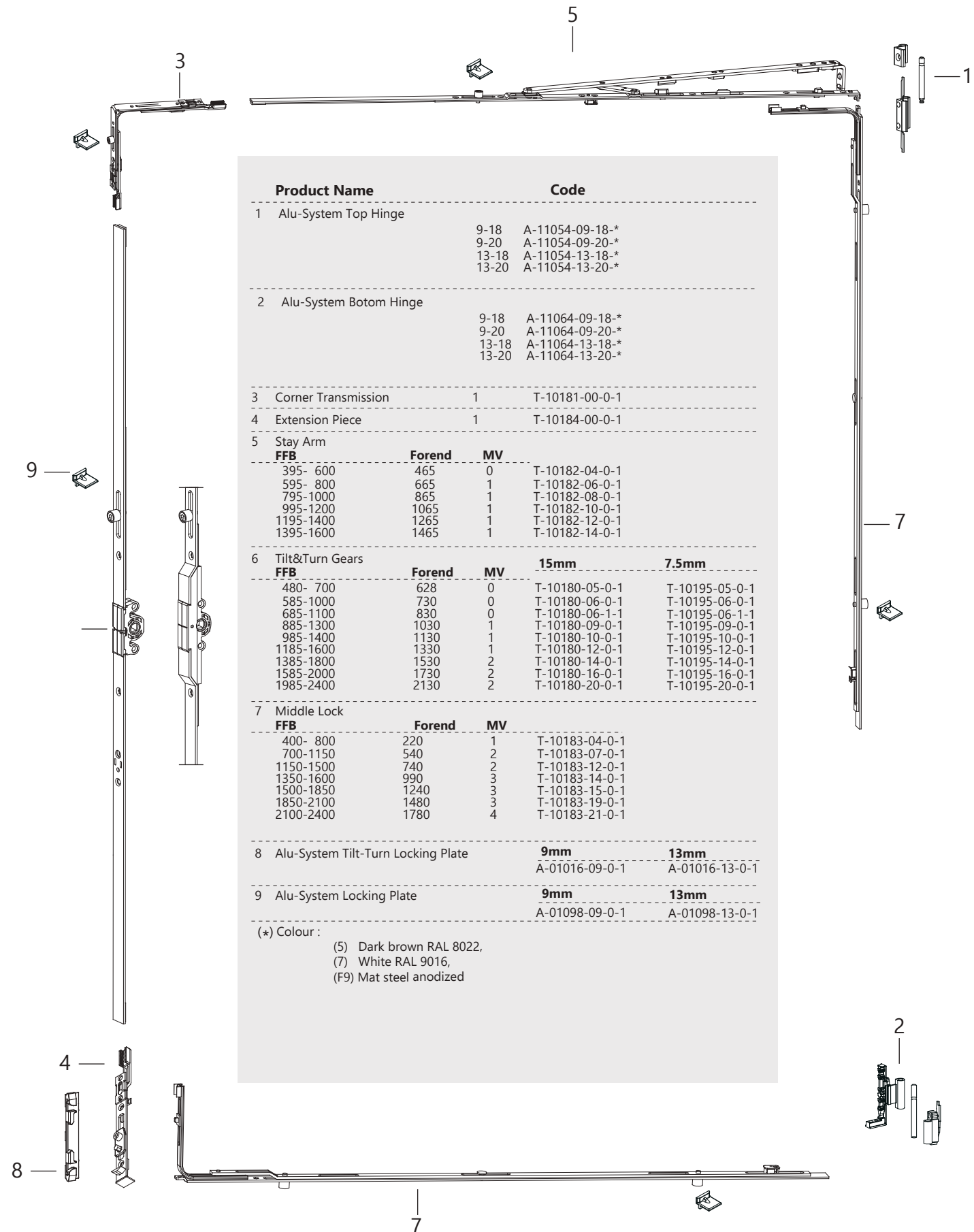

Product Name		Code			

1	Alu-System Top Hinge	9-18	A-11054-09-18-*		
		9-20	A-11054-09-20-*		
		13-18	A-11054-13-18-*		
		13-20	A-11054-13-20-*		

2	Alu-System Botom Hinge	9-18	A-11064-09-18-*		
		9-20	A-11064-09-20-*		
		13-18	A-11064-13-18-*		
		13-20	A-11064-13-20-*		

3	Corner Transmission	1	T-10181-00-0-1		

4	Extension Piece	1	T-10184-00-0-1		

5	Stay Arm	FFB	Forend	MV	
		395- 600	465	0	T-10182-04-0-1
		595- 800	665	1	T-10182-06-0-1
		795-1000	865	1	T-10182-08-0-1
		995-1200	1065	1	T-10182-10-0-1
		1195-1400	1265	1	T-10182-12-0-1
		1395-1600	1465	1	T-10182-14-0-1

6	Tilt&Turn Gears	FFB	Forend	MV	
		480- 700	628	0	T-10180-05-0-1
		585-1000	730	0	T-10180-06-0-1
		685-1100	830	0	T-10180-06-1-1
		885-1300	1030	1	T-10180-09-0-1
		985-1400	1130	1	T-10180-10-0-1
		1185-1600	1330	1	T-10180-12-0-1
		1385-1800	1530	2	T-10180-14-0-1
		1585-2000	1730	2	T-10180-16-0-1
		1985-2400	2130	2	T-10180-20-0-1
					15mm
					7.5mm
					T-10195-05-0-1
					T-10195-06-0-1
					T-10195-06-1-1
					T-10195-09-0-1
					T-10195-10-0-1
					T-10195-12-0-1
					T-10195-14-0-1
					T-10195-16-0-1
					T-10195-20-0-1

7	Middle Lock	FFB	Forend	MV	
		400- 800	220	1	T-10183-04-0-1
		700-1150	540	2	T-10183-07-0-1
		1150-1500	740	2	T-10183-12-0-1
		1350-1600	990	3	T-10183-14-0-1
		1500-1850	1240	3	T-10183-15-0-1
		1850-2100	1480	3	T-10183-19-0-1
		2100-2400	1780	4	T-10183-21-0-1

8	Alu-System Tilt-Turn Locking Plate		9mm	13mm	
			A-01016-09-0-1	A-01016-13-0-1	

9	Alu-System Locking Plate		9mm	13mm	
			A-01098-09-0-1	A-01098-13-0-1	

(*) Colour :					
		(5)	Dark brown RAL 8022,		
		(7)	White RAL 9016,		
		(F9)	Mat steel anodized		

Aluminium Window Profiles with 16mm Groove

Corner Transmission



T-10181-02-0-1
Corner Transmission, (se)



T-10181-03-0-1
Corner Transmission Small



T-10181-04-0-1
Corner Transmission Small (se)

Optional Parts for Gears



T-10189-63-0-1
Extension 630mm



T-10189-42-0-1
Extension 420mm

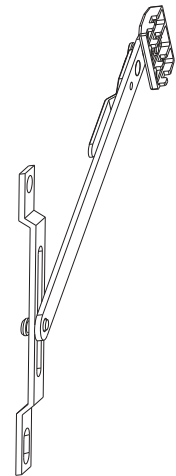

T-90001-00-0-1
Security Plate

Locking Plate

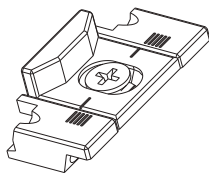

A-01090-00-0-1
Alu-System Adjustable Locking Plate

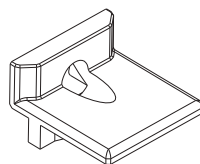

A-01098-09-S-1
Alu-System Locking Plate 9mm (se)

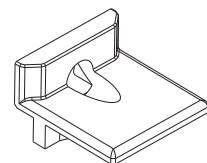

A-01098-10-0-1
Alu-System Locking Plate 10mm

FIGURE	CODE	DESCRIPTION
	A-12000-04-0-*-* A-12000-07-0-**	Tilt Turn Standard Set 360-640 mm 640-1600 mm
	Standard Set Parts A-12000-04-0-*-* A-12000-07-0-***	Stay Arm (360-640 mm)
		Stay Arm (640-1600 mm)
		Corner Transmission
		Locking Plate
		Gear Connector
		Wrong Operation Safety Device
		Tilt Lock Set

* 7: Ral 9016 - 5: Ral 8022 - F9: Mat Anodised

FIGURE	CODE	DESCRIPTION
	Standard Set Parts A-12000-04-0-* A-12000-07-0-*	Sash Lifter
		Bottom Hinge Set
		Top Hinge Set
	Optional Parts	Secondary Corner Transmission A-12020-00-0-11
		Additional Lock A-12189-00-0-1
		Additional Cam A-12022-00-0-1
		Additional Arm A-12023-00-0-1
		Handle T-61190-00-0-*
		Locking Plate A-10098-**-0-1

* 7 Ral 9016 - 5 Ral 8022 - F9: Mat Anodised

(Euro Groove)

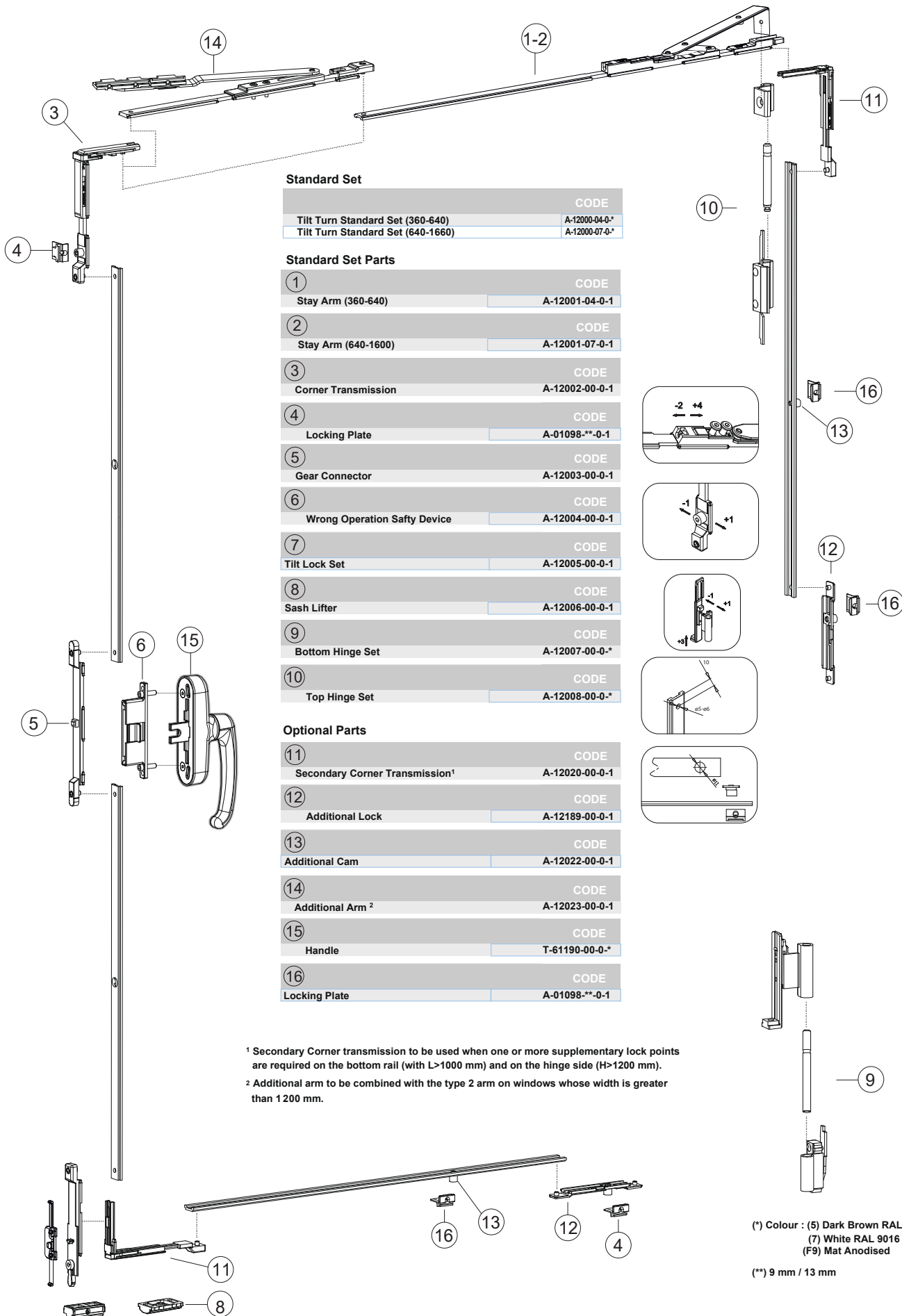

Standard Set

	CODE
Tilt Turn Standard Set (360-640)	A-12000-04-0-*
Tilt Turn Standard Set (640-1660)	A-12000-07-0-*

Standard Set Parts

	CODE
① Stay Arm (360-640)	A-12001-04-0-1
② Stay Arm (640-1600)	A-12001-07-0-1
③ Corner Transmission	A-12002-00-0-1
④ Locking Plate	A-01098.**-0-1
⑤ Gear Connector	A-12003-00-0-1
⑥ Wrong Operation Safety Device	A-12004-00-0-1
⑦ Tilt Lock Set	A-12005-00-0-1
⑧ Sash Lifter	A-12006-00-0-1
⑨ Bottom Hinge Set	A-12007-00-0-*
⑩ Top Hinge Set	A-12008-00-0-*

Optional Parts

	CODE
⑪ Secondary Corner Transmission ¹	A-12020-00-0-1
⑫ Additional Lock	A-12189-00-0-1
⑬ Additional Cam	A-12022-00-0-1
⑭ Additional Arm ²	A-12023-00-0-1
⑮ Handle	T-61190-00-0-*
⑯ Locking Plate	A-01098.**-0-1

¹ Secondary Corner transmission to be used when one or more supplementary lock points are required on the bottom rail (with L>1000 mm) and on the hinge side (H>1200 mm).

² Additional arm to be combined with the type 2 arm on windows whose width is greater than 1200 mm.

(*) Colour : (5) Dark Brown RAL 8022
(7) White RAL 9016
(F9) Mat Anodised

(**) 9 mm / 13 mm

Strength
Reliability
Security

Intelligent Solutions For Your Comfort

T / G / P



Technical
Catalog